

CONSTRUCTION & SITE MANAGEMENT PLAN

11-17 COLUMBIA LANE HOMEBUSH NSW

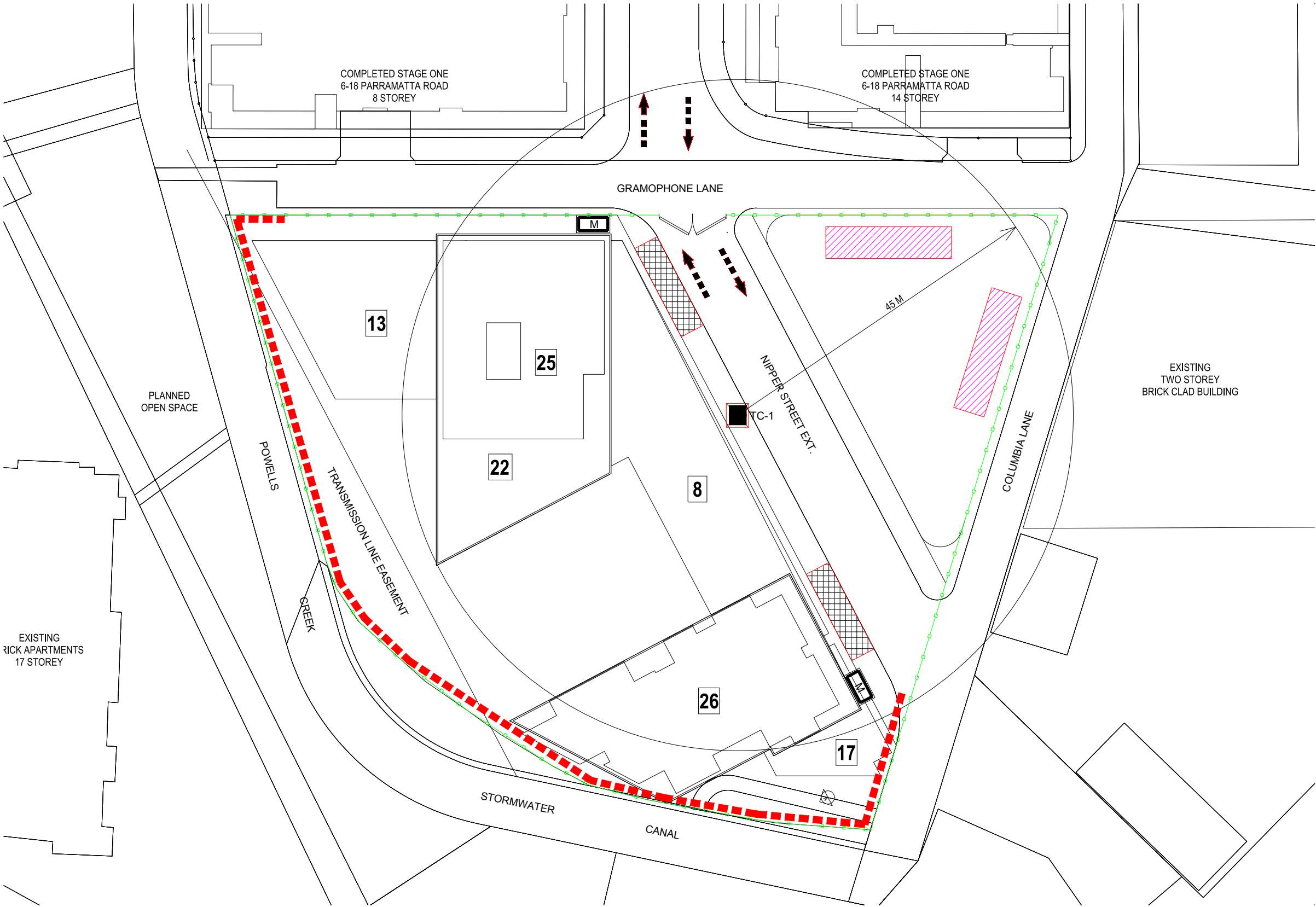

LEGEND

- Site Amenities & Parking
- Site Fence
- Temporary Fence
- Direction of traffic
- Tower Cranes
- Man & Material Host
- Gates
- Location for Concrete Pump & Construction & Loading Zone

**STRATHFIELD COUNCIL
RECEIVED**

**DA2019/143
5 September 2019**

A	FOR APPROVAL	16/09/19
REV	DESCRIPTION	DATE

JQZ-DESIGN

RETAIL 24&25, 1 NIPPER STREET HOMEBUSH NSW 2140
T 02-9578 1000 F 02-9745 2666

PROJECT

**11-17 COLUMBIA LINE
HOMEBUSH NSW 2140**

CLIENT

**COLUMBIA LANE DEVELOPMENT P/L
RETAIL 24&25, 1 NIPPER STREET HOMEBUSH**

DRAWING TITLE

CONSTRUCTION & SITE MANAGEMENT PLAN

DESIGN	SCALE	CHECKED
L.L.	NFS	B.Z.
JOB NO.	DRAWING No.	ISSUE
JQZ-HB-02	HB-CM-01	A